

- █ Bangladesh
- █ China
- █ India
- █ Indonesia
- █ Japan
- █ Korea
- █ Malaysia
- █ Pakistan
- █ Philippines
- █ Taiwan
- █ Thailand
- █ Vietnam

# Cultural / Passport Program & Food Vendors

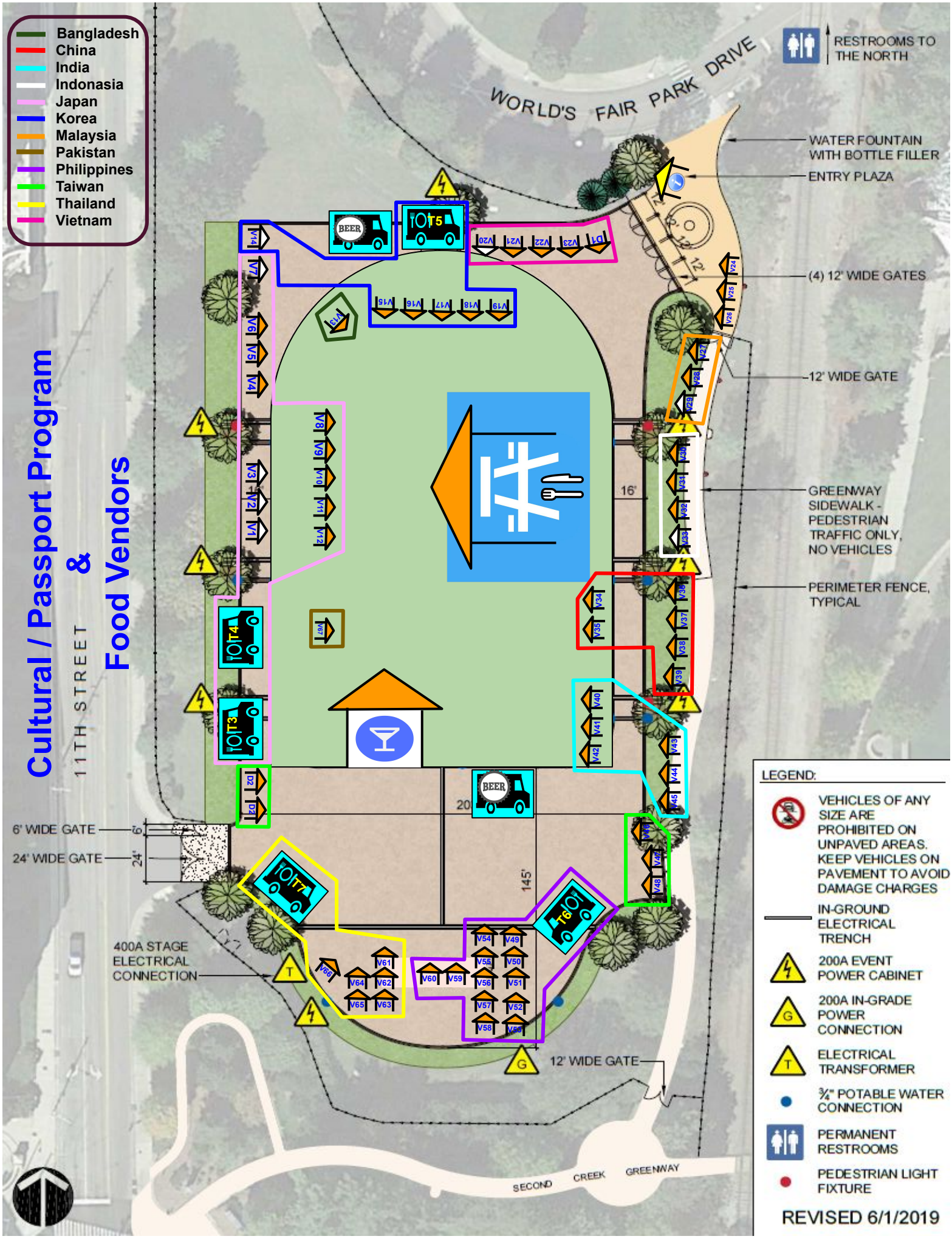

RESTROOMS TO THE NORTH

WATER FOUNTAIN WITH BOTTLE FILLER  
ENTRY PLAZA

(4) 12' WIDE GATES

12' WIDE GATE

GREENWAY SIDEWALK - PEDESTRIAN TRAFFIC ONLY, NO VEHICLES

PERIMETER FENCE, TYPICAL

6' WIDE GATE  
24' WIDE GATE

400A STAGE ELECTRICAL CONNECTION

SECOND CREEK GREENWAY

- LEGEND:**
- VEHICLES OF ANY SIZE ARE PROHIBITED ON UNPAVED AREAS. KEEP VEHICLES ON PAVEMENT TO AVOID DAMAGE CHARGES
  - IN-GROUND ELECTRICAL TRENCH
  - 200A EVENT POWER CABINET
  - 200A IN-GRADE POWER CONNECTION
  - ELECTRICAL TRANSFORMER
  - 3/4" POTABLE WATER CONNECTION
  - PERMANENT RESTROOMS
  - PEDESTRIAN LIGHT FIXTURE

REVISED 6/1/2019